

**Easel Card Kit Tutorial ('Springtime Pink Tulips Kit' is shown)
by Sue Douglas at <http://www.craftsuprint.com/sue-douglas/>**

Materials Required:

7 Sheets A4/Letter Size 160gsm/60lbs Cardstock or 160gsm/601bs to 180gsm/65lbs Photo Paper. You will use 6 sheets for the main design and 1 sheet to back the Easel Topper

8in x 8in Card Blank

Photo Glue

3d Foam Pads for Decoupage

Glitter (optional)



Easel Card - Front View



Print all 6 sheets on to 160gsm/60lbs Smooth White Cardstock or 160gsm/60lbs to 180gsm/65lbs Photo Paper. Personally I prefer to use the Photo Paper, because the colours are much more vibrant, and the finished card looks more professional. The card folds flat for posting.

Cut out all the pieces, making sure that you label the back of each piece with the specified number or letter, lightly in pencil. This is important for the Topper Top and Bottom indications, which are marked by arrows (on the sheets), and the flower decoupage layers, and will make assembling the card much easier later on.

EASEL CARD



For this step you will need the card blank and Easel Tent (A)

Take the 8in x 8in card blank and score and fold the card front at the 4in line. Score and fold along the line marked horizontally on the Easel Tent (A). Apply photo glue to the back of the Easel Tent (A) and place over the card front as shown left. This must be in the folded position as shown.

For this step you will need the card blank, Easel Inside, Stopper and Corner Decoupage (B-F)



On the inside right of the card blank apply the Inside of Card Blank (B) and using double thickness 3d foam pads place the Stopper Decoupage (C) on top. Apply the Decoupage (D) on top of the stopper, using single thickness 3d foam pads



For this step you will need the Topper (G) and a sheet of blank white card 160gsm/60lbs

Using photo glue apply the Topper (G) on to the blank sheet of card, and cut around the Topper



N.B. This step relates specifically to the Springtime Tulips design. If you have purchased a different design, please see the decoupage instructions, that can be found on the actual Decoupage sheets for that kit

For this step you will need the all the Topper Decoupage (H-J) and the Flowers Decoupage numbered 1 to 18

Apply the Topper Decoupage (H), lining up the Top and Bottom indications, with 3d Foam Pads
Apply the Topper Decoupage (J), again, lining up the Top and Bottom indications, with 3d Foam Pads
Apply the flower decoupage (collectively labeled K) labeled with numbers - starting at the top indication with number 1, work in a clockwise direction around the edge of the topper in numerical order.

N.B. On this design, the flower decoupage pieces (1-18) are for all the tulips on the design, and all the white flowers around the edge of the doily.



For this step you will need the Decoupage Topper and the Card

Apply photo glue just to the bottom half of the Topper making sure that the top and bottom indications, **are** at the top and the bottom! Place the Topper on to the bottom portion of the Tent on top of the topper positioning panel, being careful to apply the bottom edge of the topper so that it's not right to the bottom of the card edge. This is so the Decoupage on the topper doesn't collide with the raised stopper, when it's standing. Please see the side view photo of the finished card to see that the bottom white flower (which is the bottom indication) isn't touching the stopper at all, when the card is standing.



For this step you will need the Sentiment Panel (O) and the Card

Choose a Sentiment Panel (O), there are eight to choose from in this kit, including a blank panel to use with your own peel-offs or stamps. Also available, is a separate sheet with 6 different sentiment panels, should you want to purchase it for any of those sentiments.

Apply your chosen Sentiment Panel (O) to the Topper



For this step you will need the Back of Topper (L), 'Handmade by' Label (M) (optional) and Back Text Plate (N)

On the back of the card, using photo glue, apply the Back of Topper (L) and cut around the edge of the Topper

Apply the Back Text Plate (N), either with 3d foam pads or photo glue, whichever you prefer, and apply on top of the Back Text Plate positioning panel

Apply the 'Handmade by' label (M) with photo glue. (optional)

To finish apply Glitter (optional), to the decoupage flowers. I like to use a glitter that allows the colour of the design to show through it.



Side view of Finished Card

Please note how the Topper, is placed a little higher than the stopper, as explained in the last but two step, so that the Topper Decoupage, is not touching the stopper, and won't interfere with the standing of your easel card, at all

All done now! Stand back and admire your finished card!

The finished card will fold flat and will fit into the envelope that comes with your 8in x 8in Card Blank.

©2011 Sue Douglas.

<http://www.craftsuprint.com/sue-douglas/>

A few of my other designs available at CraftsUPrint – please click on the links below to see my range of A4 Kits, 8in x 8in Decoupage Sheets and Gift Card Money Envelope Kits - all of the Gift Card Money Envelope kits, have either three or four decoupage embellishments to choose from, for your Gift Envelope, which of course, you are able to use on your other card projects too!



[Gift Card Money Envelope Kits](#)



[Gift Card Money Envelope Kits](#)



[Gift Card Money Envelope Kits](#)



[Gift Card Money Envelope Kits](#)



Gift Card Money Envelope Kits



A4 Decoupage Kits

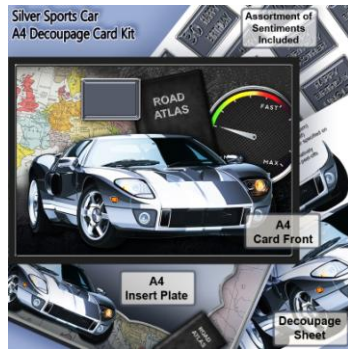

A4 Decoupage Kits

8in x 8in Steampunk Decoupage Sheets

Please Click on Specific Picture

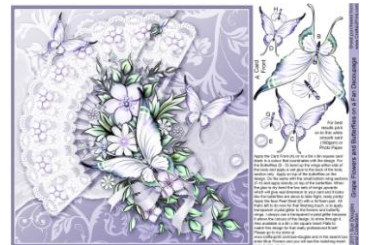

8in x 8in Decoupage Sheets

Please Click on Specific Picture



8in x 8in Decoupage Sheets
Please Click on Specific Picture



8in x 8in Decoupage Sheets
Please Click on Specific Picture



8in x 8in Decoupage Sheets
Please Click on Specific Picture

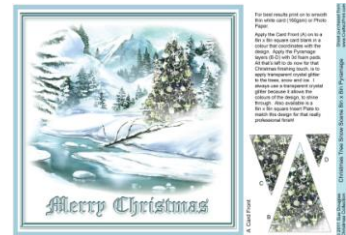
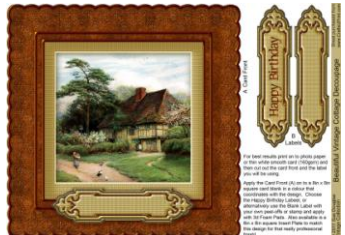

8in x 8in Decoupage Sheets
Please Click on Specific Picture

Please look out for more Easel Kits coming soon! <http://www.craftsuprint.com/sue-douglas/>